

CABLE ASSEMBLY WORK INSTRUCTION

**ePower-Lite Mini**

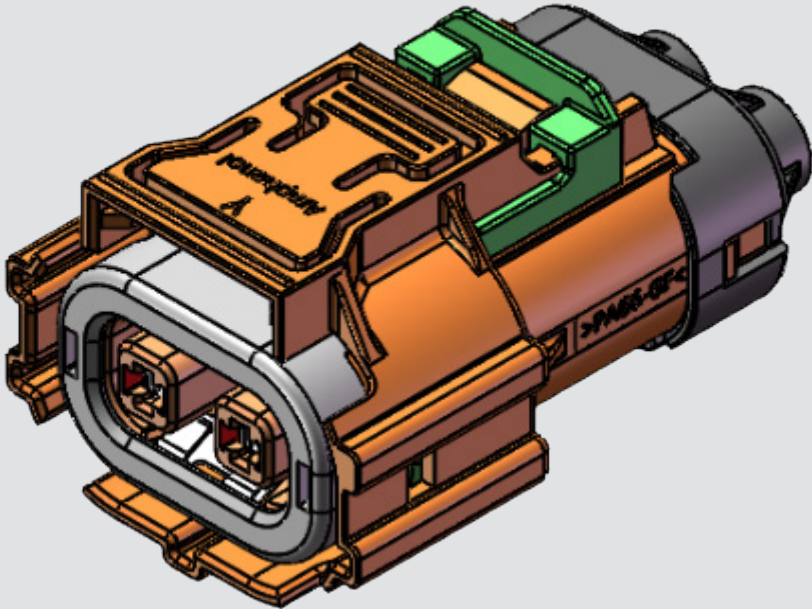

# Part 1: Package Contents

## 1. Package Contents

- 1: Plug Shell assembly
- 2: Grommet
- 3: Cable Cover
- 4: Socket contact
- 5: Outer Ferrule
- 6: Inner Ferrule

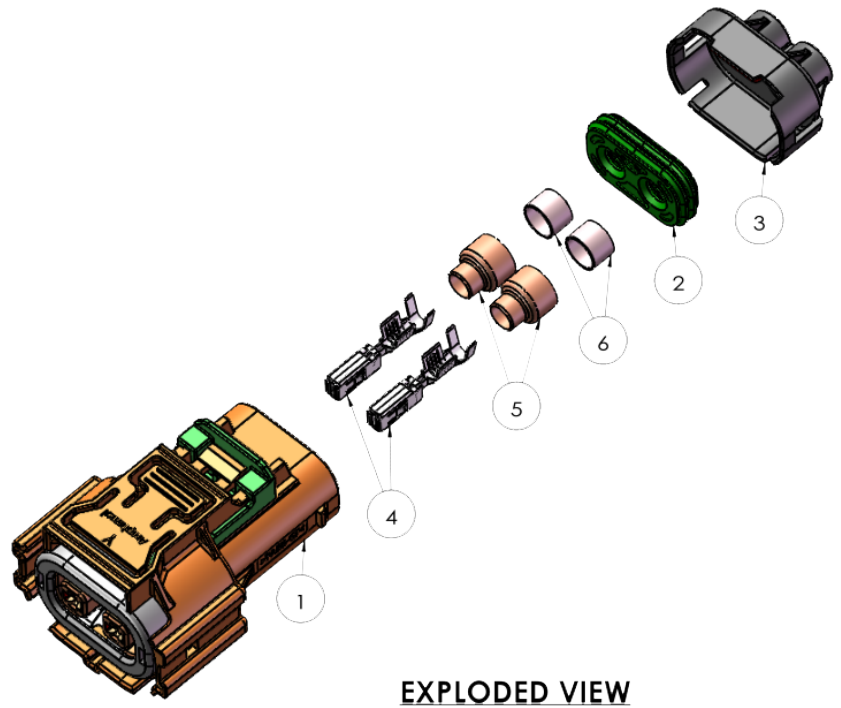

## 2. Recommended wire specification

Wire Size	Wire OD (mm)	Recommended Min. Pullout force (N)
4.0mm <sup>2</sup>	5.8 ± 0.2	325

# Part 2: Assembly

**Step 1:** Installing the inner ferrule for 4mm<sup>2</sup> wire then cutting and stripping the jacket.



Item	2 Ports (Include all cable sizes)
L	21.5 ± 0.5 mm

**Step 2:** Strip out ALU-PET foil, evenly disperse and bend the shielding net, ensure the inner ferrule is in close contact with shielding wire.

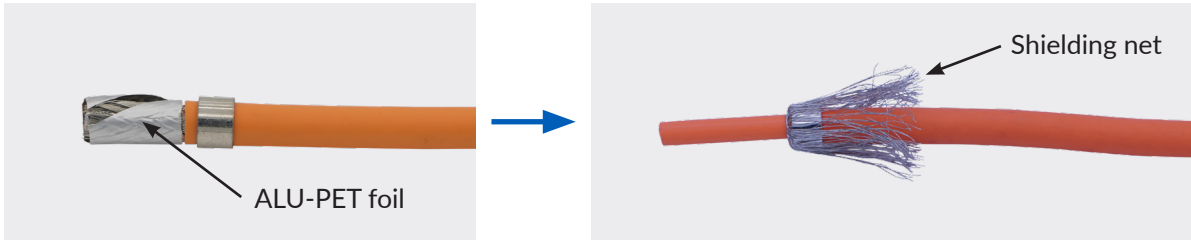

**Step 3:** Assemble the outer ferrule and crimping to right crimp height ( $7.5 \pm 0.1$  mm), cutting and the jacket.

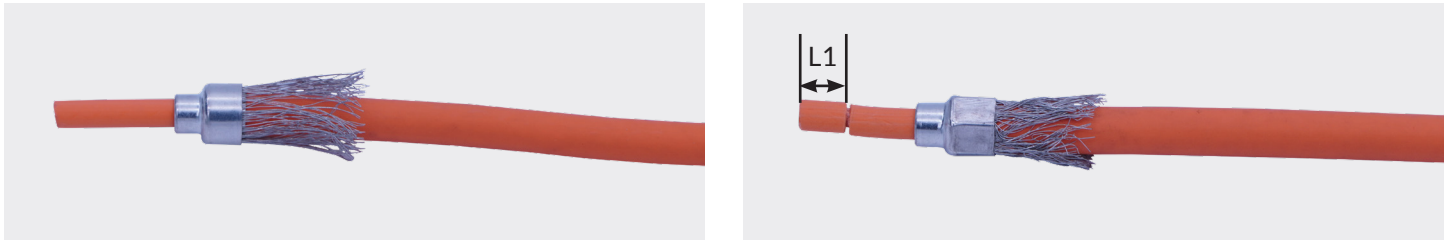

Item	2 Ports (Include all cable sizes)
L1	$5.8 \pm 0.2$ mm

**Step 4:** Stripping the jacket and cut off the exposed shielding wire of cable, crimping the terminal by right crimping tool.

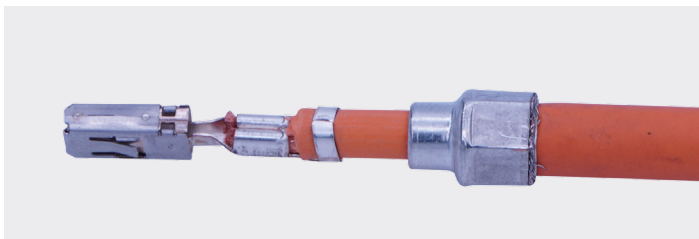

Recommended manual crimping tool as below (P/N: FX3-0094-000):



**Step 5:** Insert the contact with cable assembled into the plug shell, the collar snapped into the shoulder of the hole.

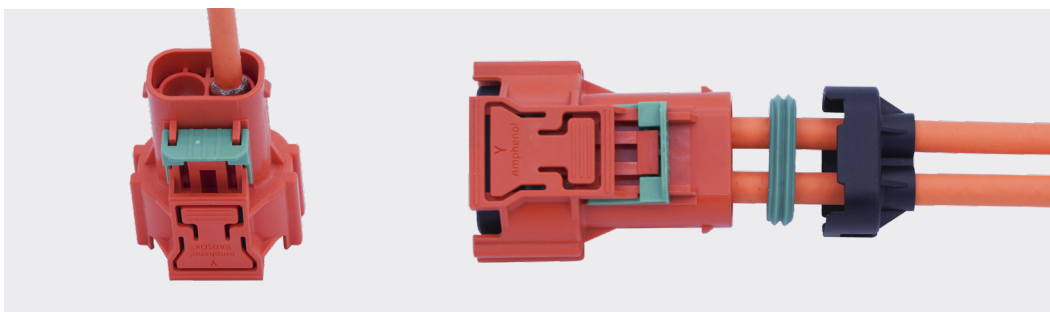

**Step 6:** Install the cable grommet.



**Step 7:** Install the cable cover

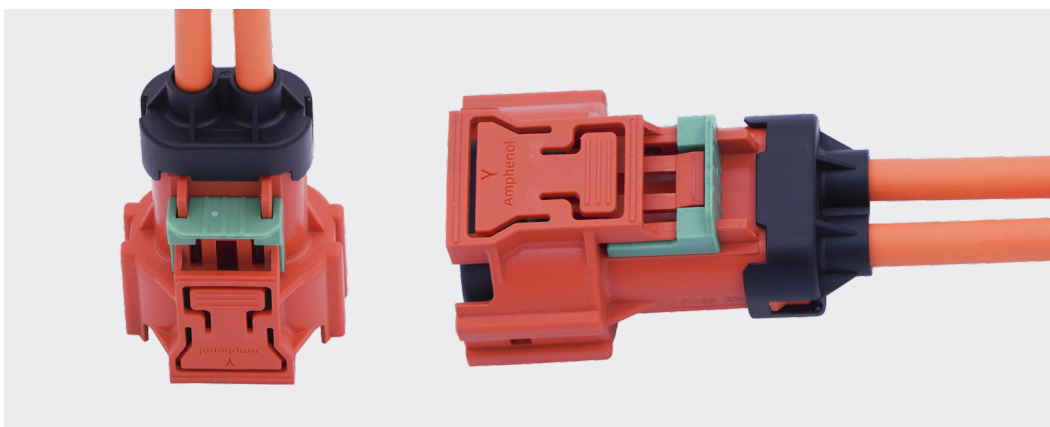

Notes:

Need to do Insulation Resistance and DWV test after cable assembly

Insulation Resistance test: 600V DC, 500M $\Omega$  Min, 60s

DWV test: 2200V AC, leakage current  $\leq$ mA, 60s

CABLE ASSEMBLY WORK INSTRUCTION

## ePower lite Mini Series Receptacle Connector

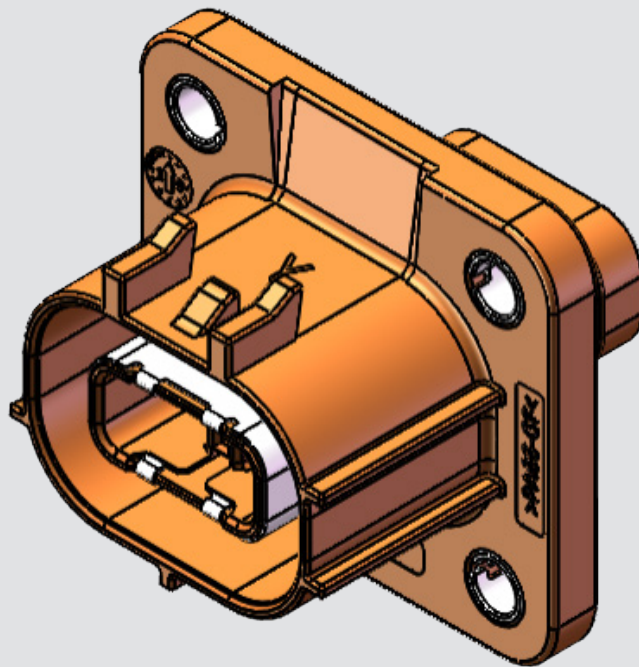

# Part 1: Package Contents

## 1. Package Contents

- 1: Receptacle Shell Assembly
- 2: Power Pin Contact
- 3: Socket Contact

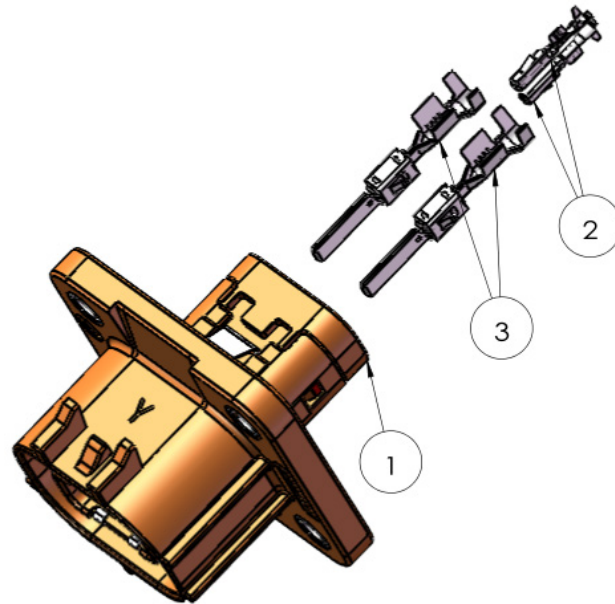

**EXPLODED VIEW**

# Part 2: Assembly Steps for Power Pin

**Step 1:** 4mm<sup>2</sup> wire cutting and stripping jacket dimensions

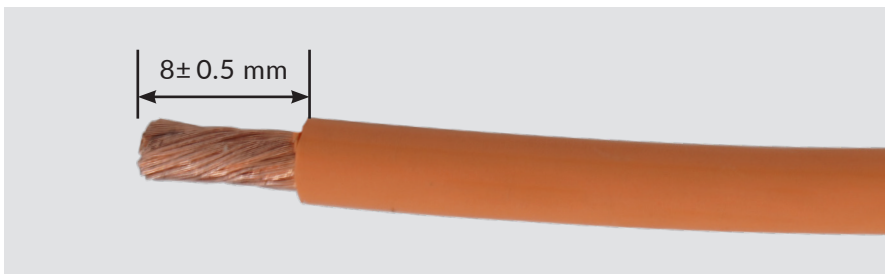

**Step 2:** Insert conductor into hole of socket and crimping use right crimping tool

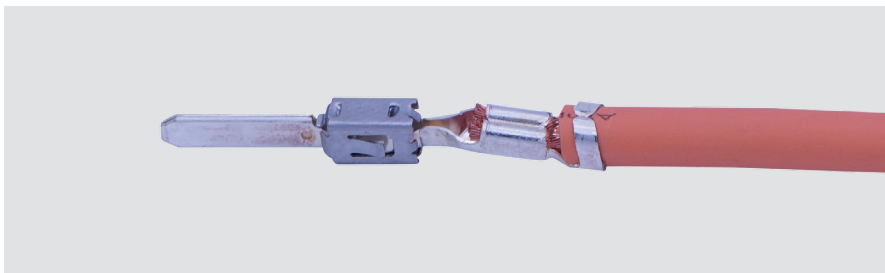

Wire Size	Recommended Min. Pullout force (N)
4.0mm <sup>2</sup>	325

Recommended manual crimping tool as below (P/N: FX3-0094-000):

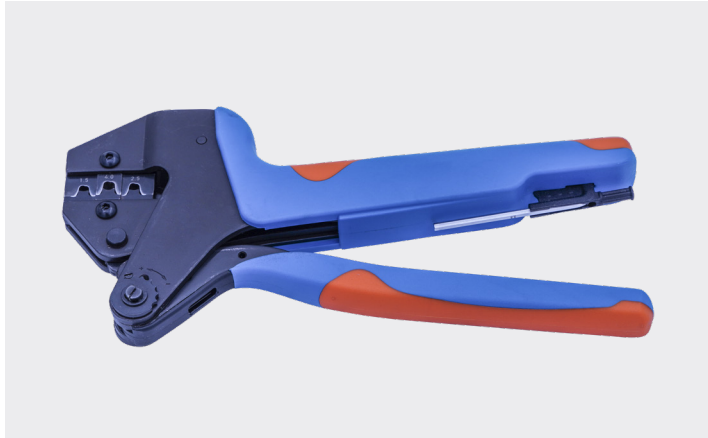

**Step 5:** Insert the contact with cable assembled into the plug shell, the collar snapped into the shoulder of the hole.

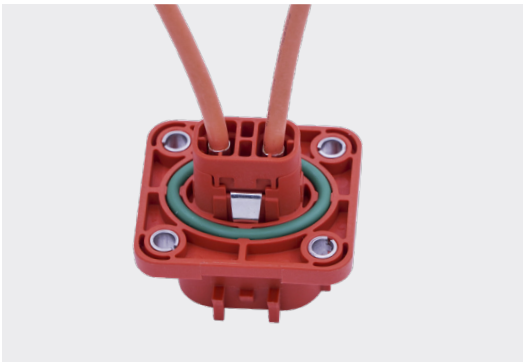

## Part 3: Assembly Steps for HVIL pin

**Step 1:** Wire cutting and stripping the jacket



**Step 2:** Insert conductor into hole of socket and crimping use right crimping tool





## Recommended HVIL Wire Specification

Receptacle	HVIL Wire Size	Recommended Min. Pullout force (N)
2 ports	22 AWG	40
	20 AWG	60

Recommended Crimping tool as below (P/N: FX3-0095-000):



**Step 3:** Insert the HVIL contacts into the receptacle shell assembly, the claws face to the sides

